

01 Rada 215dk TMV Boxes

Recessed model shown

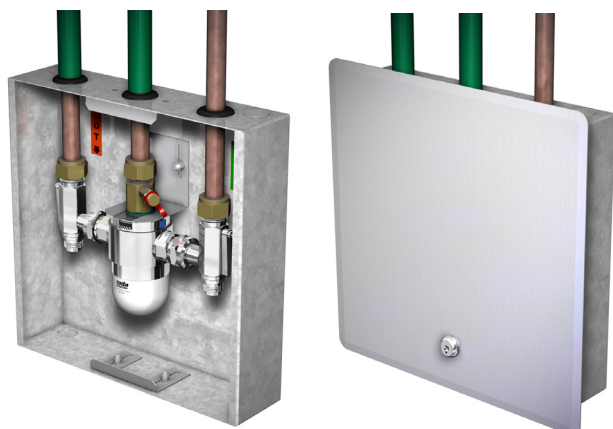

Line Drawings

06

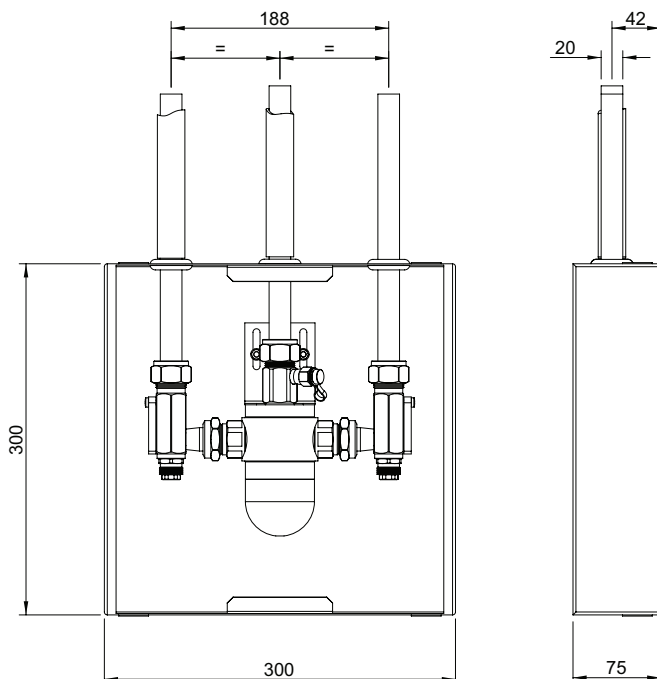
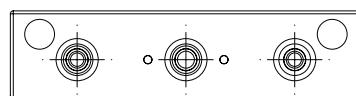

02 Product Part Numbers

Product Description	Part No
Rada 215dk TMV in a recessed galvanised box with stainless steel lid	40861RB300
Rada 215dk TMV in a recessed galvanised box with stainless steel lid (with cold water feed)	40861RB300CF
Rada 215dk TMV in an exposed galvanised box and lid	40861EBG300
Rada 215dk TMV in an exposed galvanised box and lid (with cold water feed)	40861EBG300CF

03 To Specify (Recessed model 40861RB300)

Rada 215dk TMV in a recessed galvanised (300 x 300 x 75mm) box with stainless steel lid. Flow rate 2.5 - 50 L/ min. Incorporating a sealed-for-life, service free Radatherm cartridge; inlet check valve & strainer cartridges; inlet isolating ball valves; outlet temperature test point; and 20mm copper inlet & outlet pipework. Approvals: AS 4032.1 and NSW Health.

04 Approvals



NSW HEALTH APPROVED



05 CAD Drawings

CAD drawings can be obtained by contacting us on (02) 9417 4466 or by emailing your request to enquiries@thornthwaite.com.au.